

Thule Rain Blocker G2 - Front Panel

Easily create your own privacy

Information

- Height (A) 2.30m
= The height of the front panel
- Width (B) 1.00m, 1.50m, 1.75m, 2.00m
= The approximate width of the panel
- Colours Black, white, grey (non-transparent)
- Available for following Thule Omnistor awnings:
 - + 8000, 5200, 5003, 4900, 9200, 6200, 1200, 2000, 5102
 - + 5002, 6900, Tristor, TristorII, V10XL

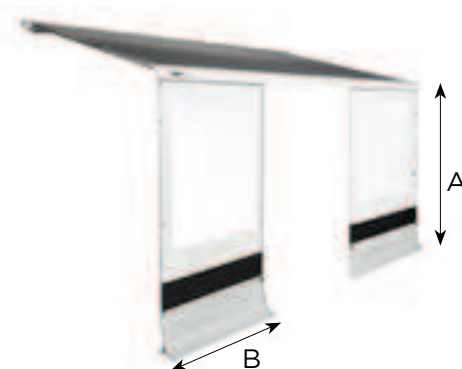

Specifications

- Protects against wind and rain while keeping the incidence of light thanks to the large window
- Easy and quick installation
 - + the front panel slides into the lead rail of the awning
 - + all panels can be rolled up and are fixed with a side release buckle
- Modular system:
 - + many possibilities to combine the different panels thanks to smart connections
 - + the combination of a panel with the QuickFit or EasyLink tent is possible (only if the tent is smaller than the awning and there is some space in the channel to slide the panel)
 - + can't be combined with a Thule Rain Blocker G2 - Small Side Panel
- Durable materials:
 - + top-quality PVC fabric with welded connections of the fabric
- Included:
 - + smart connections to connect with other Thule Rain Blocker G2 Front Panels
 - + 1 front panel
 - + pegs and pins

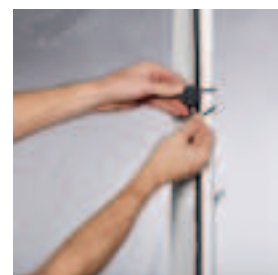

Related Products

- Thule Windscreen
- Thule Rain Blocker G2 - Side Panel
- Thule Sun Blocker G2 - Side Panel
- Thule Sun Blocker G2 - Front Panel

Modularity



Front Combinations

- When desired, a full front combination can be made
- Connection pieces to the next front are included
- Thule advises following combinations:

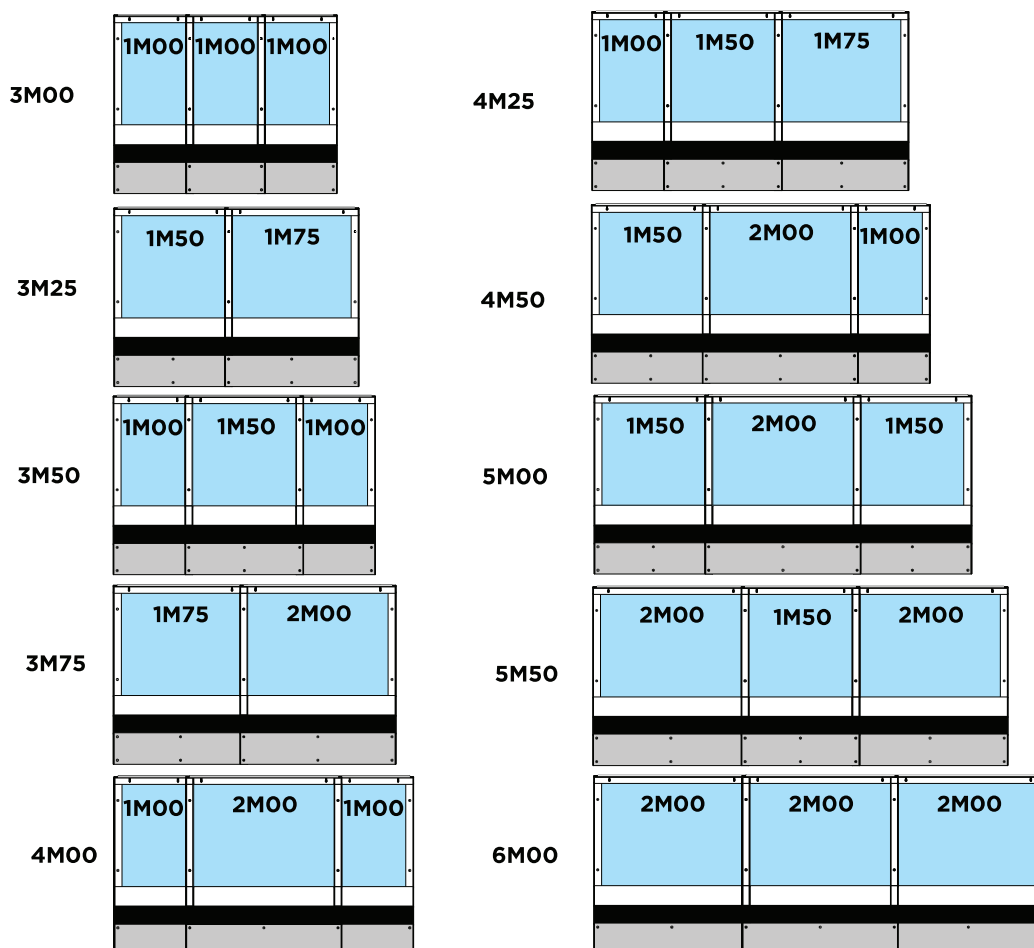

Product References Thule Rain Blocker G2 - Front Panel

| Product ref. | Width (B) | Height (A) | Weight (bruto) |
|--------------|-----------|------------|----------------|
| 307303 | 1.00m | 2.30m | 2.00kg |
| 307304 | 1.50m | | 2.50kg |
| 307305 | 1.75m | | 2.75kg |
| 307306 | 2.00m | | 3.00kg |

THULE SMART PANELS

